

# Fixed castor CDF 125 LEK

Transport Series CD - Wheel E

 -20 °C - +70 °C

  
swivels easily

  
wear resistant

  
shock proof

  
floor protective

  
weather proof

## Wheel



Tread: Elastic solid rubber tyre, black, 73±5 Shore A, vulcanised on wheel centre

Wheel centre: Die-cast aluminium alloy

## Fork



Finish: electro-zinc plated, double ball bearing – revited, hardened steel balls thermoplastic dust protection ring, wheel axle bolted, total lock

Fixed castor	Wheel-Ø A x width B mm: 125x40
--------------	--------------------------------

Load Capacity kg:	120
-------------------	-----

Load capacity tested according to EN 12530 and EN 12527	
---	--

Overall height H mm:	154
----------------------	-----

Dimension of top plate TP mm:	102x83
-------------------------------	--------

Hole spacing HS mm:	80x60
---------------------	-------

Hole-Ø HD mm:	9
---------------	---

Wheel bearing:	Ball bearing
----------------	--------------

## Advantages

- ✓ excellent running performance
- ✓ very silent in motion
- ✓ low rolling resistance
- ✓ good abrasion resistance
- ✓ corrosion resistant
- ✓ non-marking in grey

©Copyright 2024 Rollenbau GmbH, [www.rollenbau.at](http://www.rollenbau.at) 20.05.2024

 ROLLENBAU

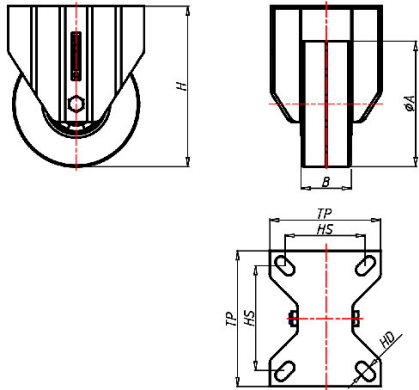

## Applications

- Bins
- Refuse bins
- Dollies
- Trash containers
- Refuse containers